

West Campus Green Design and Implementation Plan



West Campus Green Design and Implementation Plan Contents

1. Project Background, Goals and Vision
2. Site Analysis
3. Site Proposal
4. Implementation

Project Background, Goals and Vision

Land Acknowledgment

The University of Washington acknowledges the Coast Salish peoples of this land, the land which touches the shared waters of all tribes and bands within the Suquamish, Tulalip and Muckleshoot nations.

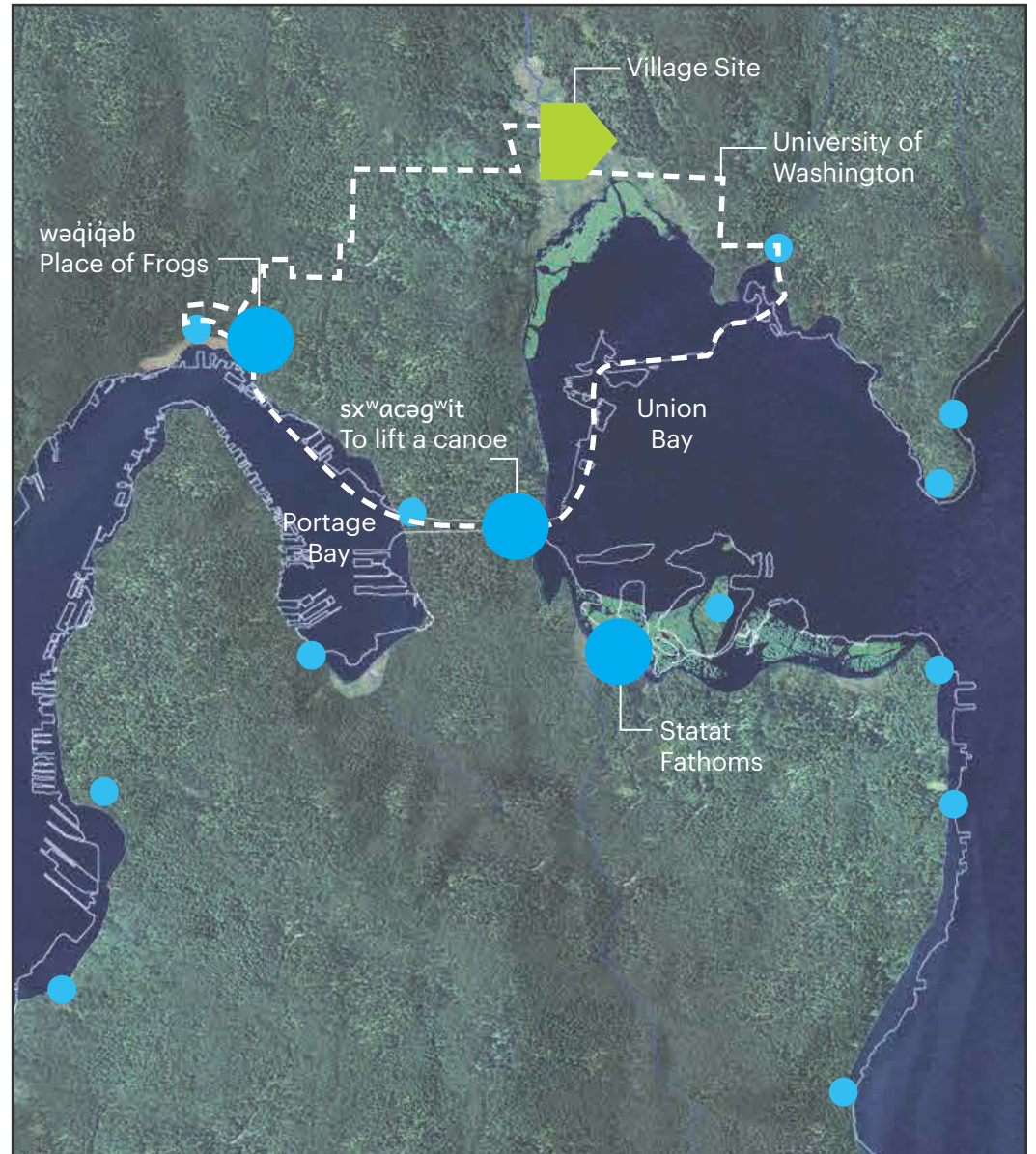

Area of the Waterlines Project Map, coordinated by the Burke Museum
https://www.burkemuseum.org/static/waterlines/project_map.html

The Waterlines Project Map is a rendering of the Seattle region in the mid-19th century, just prior to non-Indigenous settlement, created using photorealistic aerial views collaged with hand painting.

2019 Campus Master Plan (CMP)

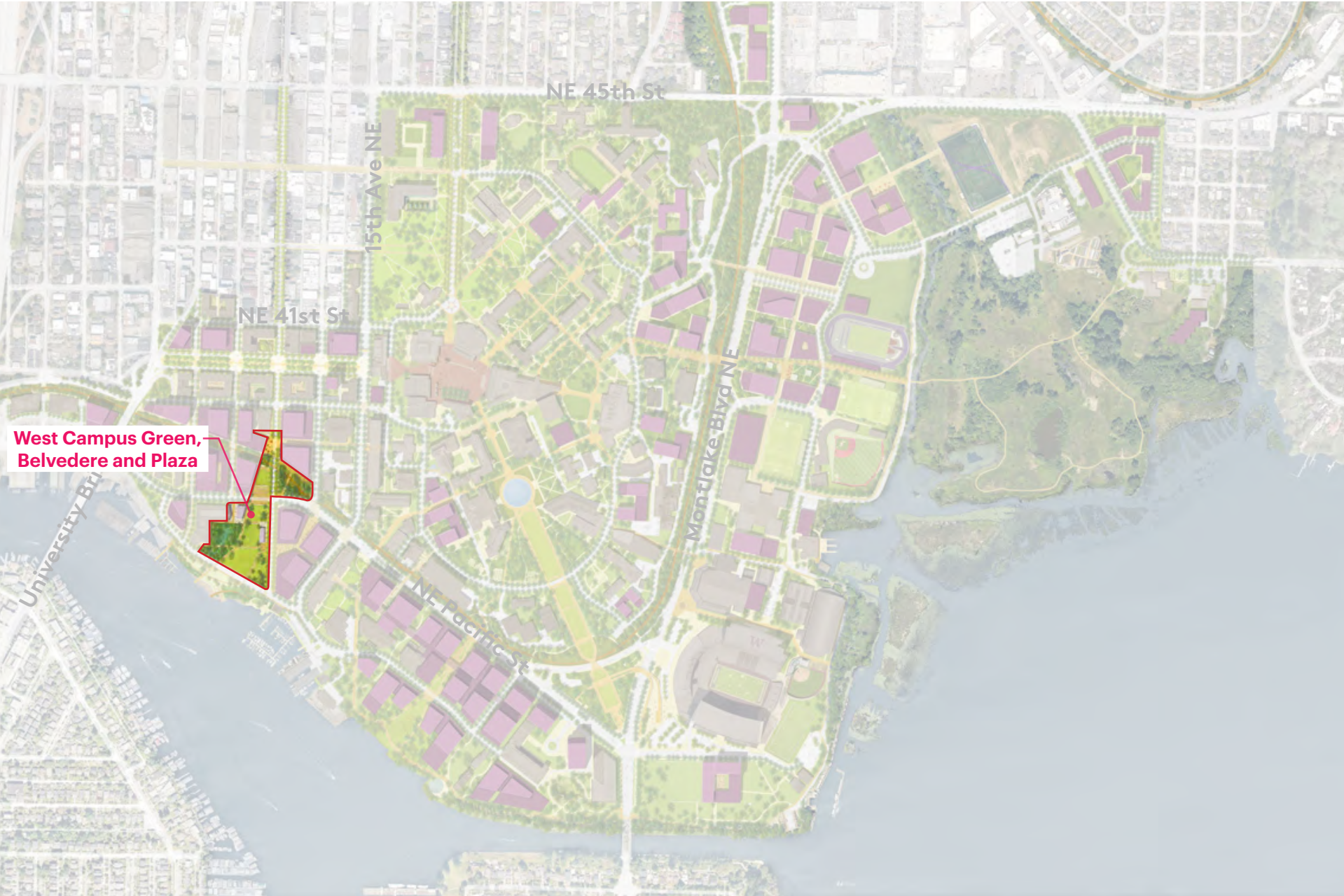

West Campus Green Tied to CMP Development Sites

Per the terms of the 2019 Campus Master Plan, the construction of the West Campus Green needs to precede a certain level of new development authorized under the plan. UW could build the WCG well in advance of these triggers in order to help catalyze the growth of the West Campus and also to preclude any delays to desired development caused by unanticipated delays in the permitting, funding, or approvals for the WCG.

West Campus Green construction needs to be complete before:

- 3M GSF constructed in the West Campus sector;
- Construction of sites W29, W33, and W34; or
- Exhaustion of the 6M GSF CMP growth allowance.

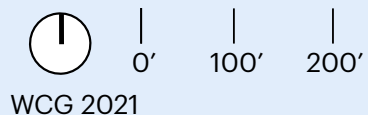
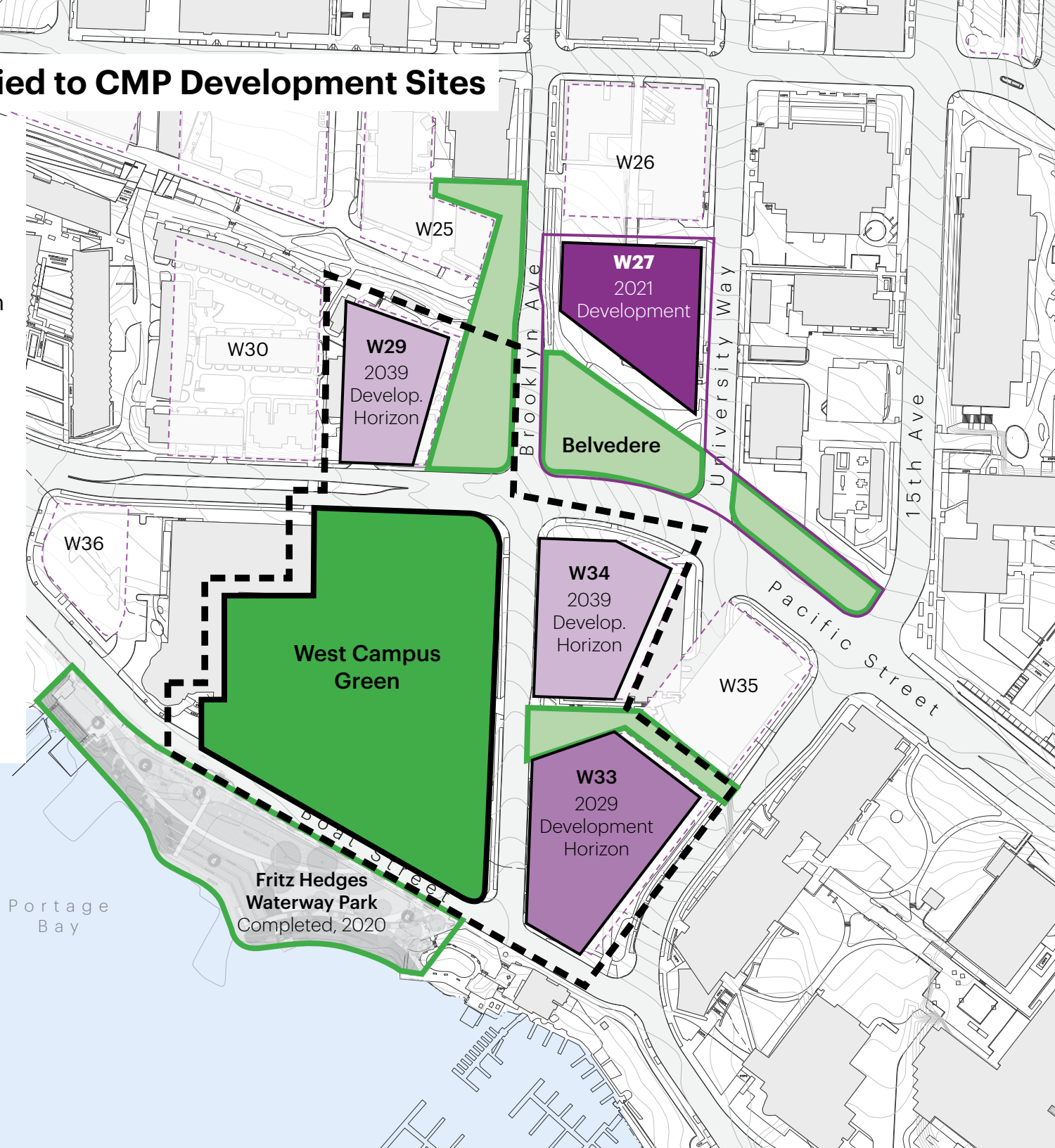

Project Goals

- Ensure the campus' significant open space features are designed in a manner that provides a welcome setting that **activates the public realm for existing and future adjacent development** and implemented in the required timeframe, as outlined in UW 2019 Seattle Campus Master Plan, and as a catalyst for development.
- Develop **an open space that establishes an enduring image and identity of the UW's West Campus** that will serve as the basis of design for, and is attuned to, future adjacent conditions, campus circulation, and development opportunities that will be built incrementally.
- Emphasize the University and community's **connection to the waterfront** through an open and inclusive design that provides visual and physical connections from the West Campus to the City of Seattle's new Fritz Hedges Park.
- Create a new significant open space that **encourages exploration and social interaction** for groups large and small, with a variety of flexible spaces and functional landscape typologies.
- Identify **private/public partnership opportunities** for campus green development and maintenance.
- Demonstrate **stewardship of historic, cultural and ecological resources**, including sustainable innovative approaches to ecology, hydrology, planting, and maintenance of an urban open space in anticipation of a warming climate.

2019 Campus Master Plan Guidelines

1. Support and prioritize the CMP Shoreline Public Access Plan to preserve the shoreline environment and enhance public access moments to the waterfront (pg. 108-111).
2. Respect View Corridors 9 and 10 in the West Campus (pg. 252-253).
3. Reinforce connections between campus sectors and create a flexible and multi-purpose open space complementing and extending the City's Fritz Hedges Waterfront Park (pg. 193).
4. Envision Brooklyn Avenue as a pedestrian-oriented street with bicycle connections to Boat St and an east-west mid-block crossing (pg. 193).
5. Respect natural, educational and "working" spaces alike.
6. Allow for flexible transportation choices/options.

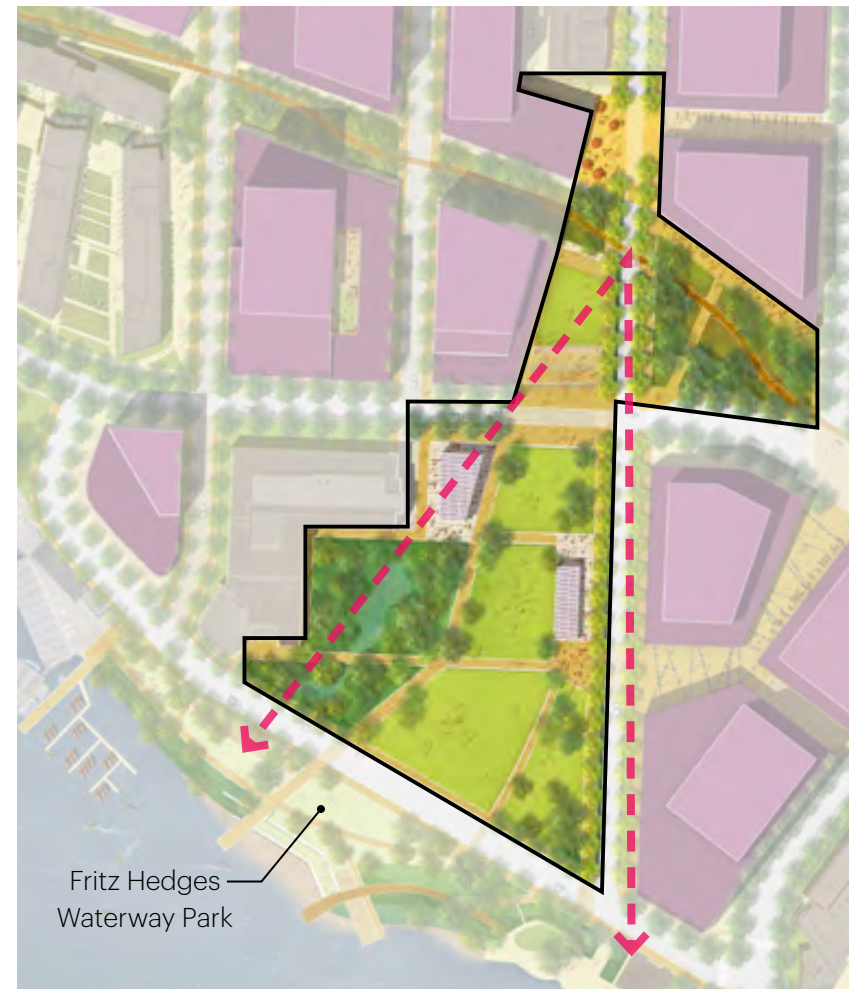

2019 Campus Master Plan

Site Analysis

Network of Significant Open Space



Planned West Campus Open Space as per 2019 Campus Master Plan

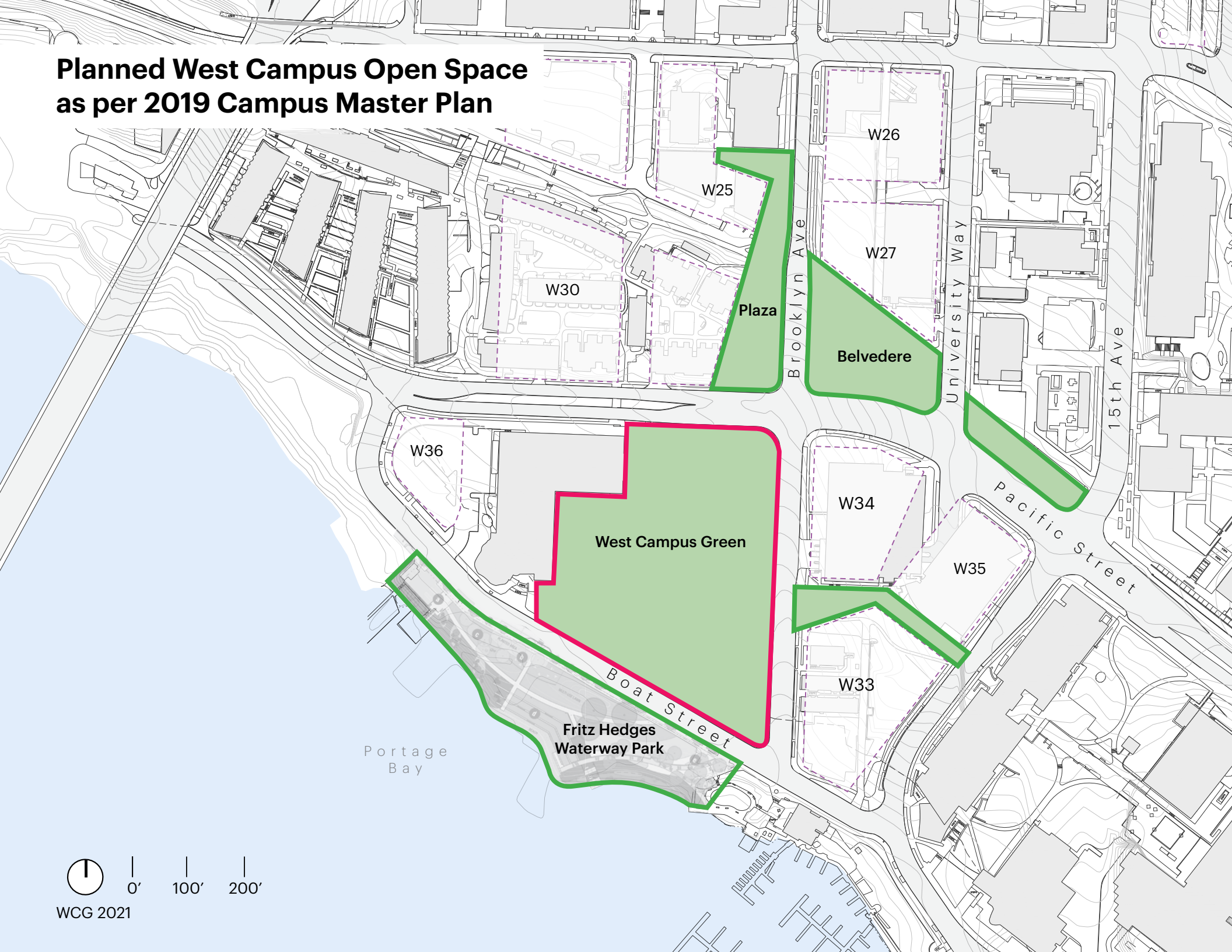

West Campus

Exiting the new U-District Link light rail station, people from all over the region can take a leisurely walk down an official City of Seattle Green Street (Brooklyn Avenue) to reach the celebrated UW waterfront. Traveling along the Burke- Gilman Trail, bikers, scooters, skateboarders, and pedestrians will cross the Belvedere, a small parklet adjacent to the trail and a landscape that creates a new accessible route down to Pacific Avenue, leading to the West Campus Green.

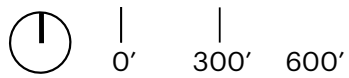

WCG 2021



Existing Conditions



West Facade of Wallace Hall

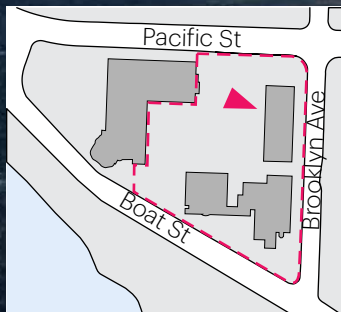

Wallace Hall's windowless west facade includes a loading dock but no pedestrian-scale entries.

East Facade of Fishery Sciences Building

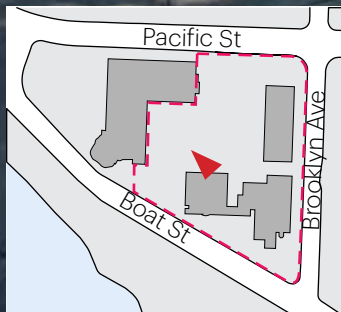
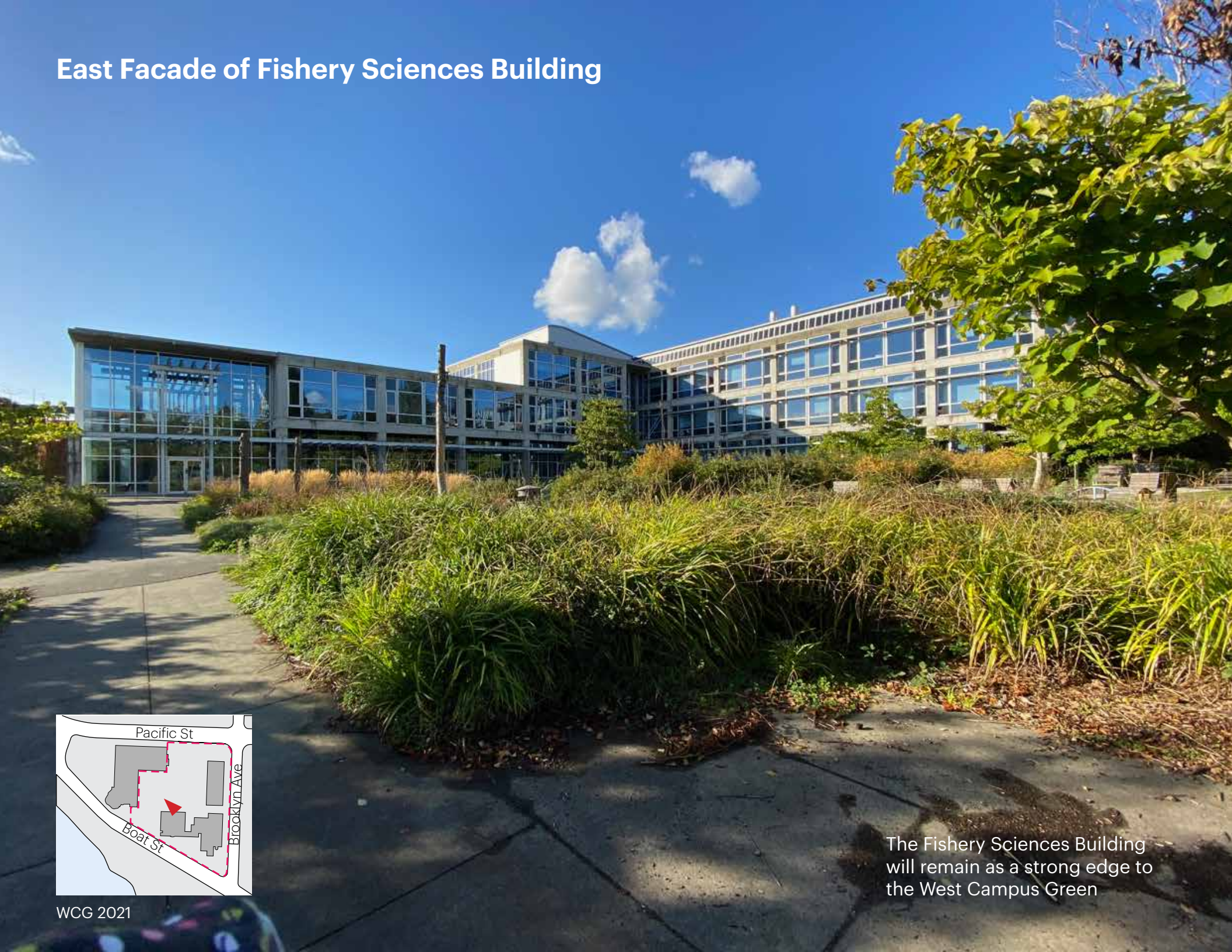

The Fishery Sciences Building will remain as a strong edge to the West Campus Green

Existing View from Boat Street

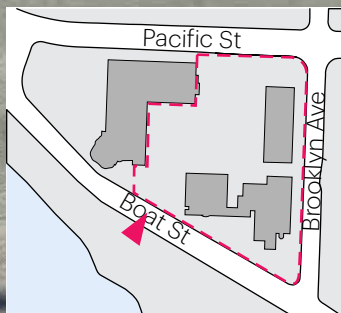

The site enjoys full southern exposure, but views to the northeast are blocked by dense vegetation.

View from Fritz Hedges Waterway Park

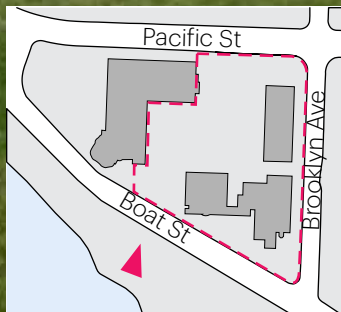

The new city park connects West Campus Green to Portage Bay and to the UW's Continuous Waterfront Trail

Design Considerations

Neighborhood Park or Campus Space?

How can the West Campus Green offer the best of both?



Pier 1, Brooklyn Bridge Park, NY



The Quad, UW



Pier 6, Brooklyn Bridge Park, NY



Drumheller Fountain, UW

Programming Opportunities

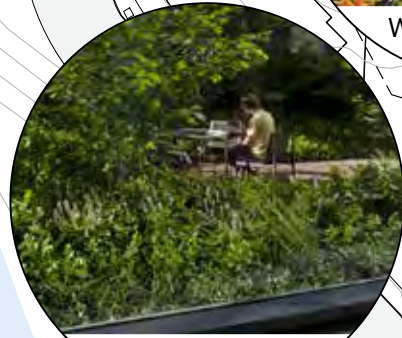

Green Escape



Wetland Garden



Small Scale Social Games



Ornamental Planting



Active Recreation



Street Fair



Flexible Space



Granite Prospect



Play Space

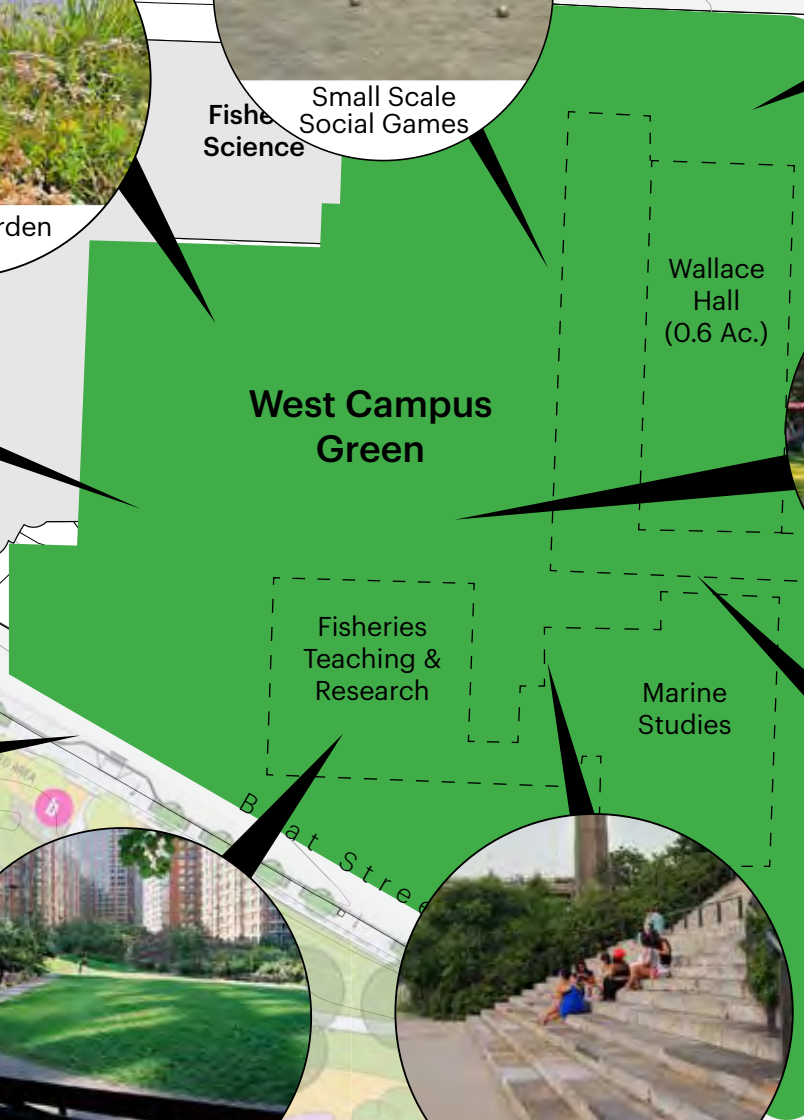

Reflecting Indigenous Culture in the West Campus Green

Conversations with Indigenous students at UW resulted in a number of suggestions about how the West Campus Green could communicate different aspects of Indigenous culture.

Indigenous language

- Southern Lushootseed specifically.
- Use prominently along with English translation, look for ways to teach pronunciation.
- Create naming opportunities that relate to natural landmarks or environments, rather than celebrating individuals.
- Highlight cardinal directions.

Involve an Indigenous artist, preferably Coast Salish

Interpretive Story / History

- References to the waterway and Indigenous knowledge systems related to water.
- Given the proximity to the School of Aquatic and Fishery Sciences, reference treaty rights related to fishing.
- Boldt Decision / 1970's Native American Rights Movement in Seattle.
- American Indian Religious Freedom Act 1978.

Contemporary practices that could be incorporated

- Spaces for ceremonies, celebration, and dance.
- Showcase native plants and ethnobotany.
- Smudging Ceremonies should be allowed.



Guests of the Great River, at the Burke Museum,
Created by Chinook Artist Tony A. (naschio) Johnson and Adam McIsaac

Keeping or Removing Wallace Hall

Wallace Hall was constructed in 1976, which means that it was constructed over 25 years ago. Its age means that Wallace Hall might be eligible to be declared a City Landmark, if the City's Landmarks Board deems that it meets the criteria for designation. Without knowing how the Landmarks Board will rule on this question, there exists a possibility that the Wallace Hall will need to be preserved as part of the future West Campus Green. There are ways that the future West Campus Green can be designed to incorporate Wallace Hall, with a variety of impacts identified on the adjacent diagrams.

Given the landscape impact of keeping the structure, and given that the UW's agreement with the City of Seattle prioritizes the creation of a sizable green space, the assumption is that Wallace Hall will be removed if City Landmarks Board determines that it is not a City Landmark.

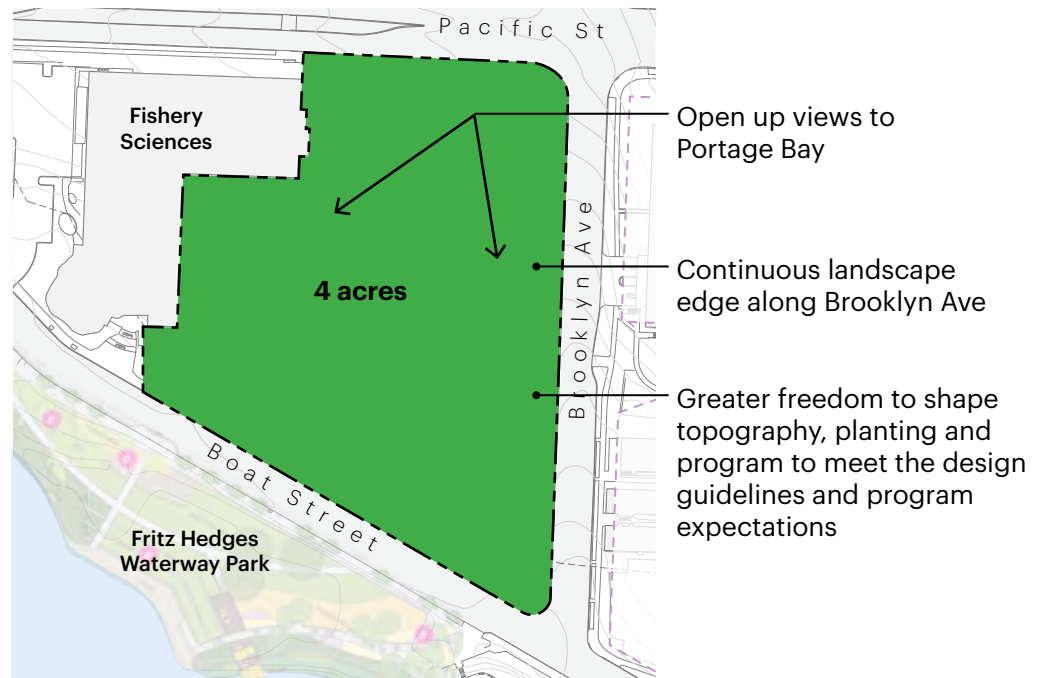

West Campus Green Concept

Arriving at West Campus Green from the north, visitors will enter through the **Pacific Entry**, offering access to a range of experiences and activities – open lawns shaped by robust planting, seating areas, pathways, plazas and courtyards. Conversations with UW Recreation indicate that there is strong interest in seasonal programming of these spaces with different types of recreation, such as lawn sports and games. To the west, **Fishery Court**, shaped by planting and offering seating and tables, will provide outdoor gathering space for faculty and students as well as general users.

An east-west walkway transects the West Campus Green, creating a strong pedestrian axis with the health sciences campus to the east. **Boat Street Lawn** will slope gently toward the water and can sometimes serve as a festival space, perhaps linked to times that Boat Street can be closed to car traffic. Connecting across Boat Street to **Fritz Hedges Waterway Park**, visitors can access water-based recreation and the UW waterfront. Views across Portage Bay can be admired from multiple locations within West Campus Green and along the public waterfront.

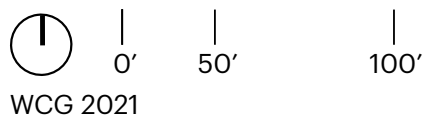

West Campus Green Concept with Wallace Hall

If the City of Seattle was to determine that Wallace Hall merits a Landmarks Designation, the plan would need to be adjusted to accommodate the structure within a new park setting.



West Campus Green Context and Concept



Implementation

Phasing Recommendation #1:

Build the WCG in a Single Phase



WCG Preferred Concept

- Program Space
- Lawn
- Trees and Planting



WCG Concept with Wallace Hall



Phasing Recommendation #2:

Build the WCG in Two Phases, Starting with the North



Phase 1

- Program Space
- Lawn
- Trees and Planting
- Temporary Planting



Phase 2



Phasing Recommendation #3:

Build the WCG in Two Phases, Starting with the South



Phase 1

- Program Space
- Lawn
- Trees and Planting

Phase 2



Phasing Recommendation #3A:

Build the WCG in Two Phases, Starting with the South



Phase 1

- Program Space
- Lawn
- Trees and Planting

Phase 2



